

OPTIONAL PARTS

NO.	PART NO.	DESCRIPTION	QTY.
1	001	WHEEL ASSEMBLY	4
2	002	CASTER	4
3	003	WHEEL ASSEMBLY	4
4	004	CASTER	4
5	005	WHEEL ASSEMBLY	4
6	006	CASTER	4
7	007	WHEEL ASSEMBLY	4
8	008	CASTER	4
9	009	WHEEL ASSEMBLY	4
10	010	CASTER	4
11	011	WHEEL ASSEMBLY	4
12	012	CASTER	4
13	013	WHEEL ASSEMBLY	4
14	014	CASTER	4
15	015	WHEEL ASSEMBLY	4
16	016	CASTER	4
17	017	WHEEL ASSEMBLY	4
18	018	CASTER	4
19	019	WHEEL ASSEMBLY	4
20	020	CASTER	4
21	021	WHEEL ASSEMBLY	4
22	022	CASTER	4
23	023	WHEEL ASSEMBLY	4
24	024	CASTER	4
25	025	WHEEL ASSEMBLY	4
26	026	CASTER	4
27	027	WHEEL ASSEMBLY	4
28	028	CASTER	4
29	029	WHEEL ASSEMBLY	4
30	030	CASTER	4

NO.	PART NO.	DESCRIPTION	QTY.
31	031	WHEEL ASSEMBLY	4
32	032	CASTER	4
33	033	WHEEL ASSEMBLY	4
34	034	CASTER	4
35	035	WHEEL ASSEMBLY	4
36	036	CASTER	4
37	037	WHEEL ASSEMBLY	4
38	038	CASTER	4
39	039	WHEEL ASSEMBLY	4
40	040	CASTER	4
41	041	WHEEL ASSEMBLY	4
42	042	CASTER	4
43	043	WHEEL ASSEMBLY	4
44	044	CASTER	4
45	045	WHEEL ASSEMBLY	4
46	046	CASTER	4
47	047	WHEEL ASSEMBLY	4
48	048	CASTER	4
49	049	WHEEL ASSEMBLY	4
50	050	CASTER	4

PARTS LIST

WILLIAMS
 HEALTHCARE
 ECKARD HEALTH SYS. TABLE
 PART NO. 001003
 QTY. 1
 MATERIAL: STEEL
 DIMENSIONS: 117" x 51" x 28"
 WEIGHT: 110 LBS
 DATE: 07/03/03
 DRAWING NO. END-30

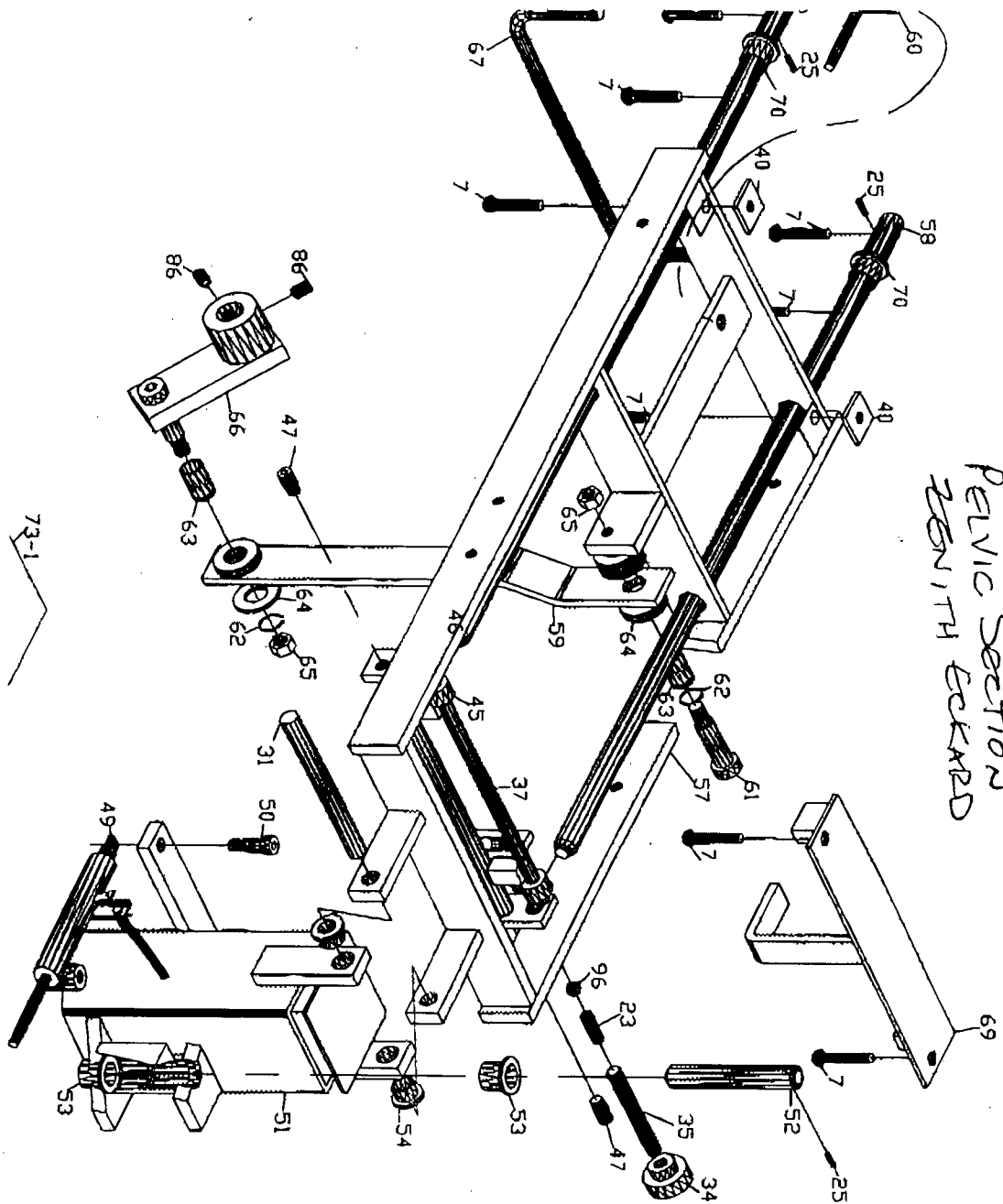

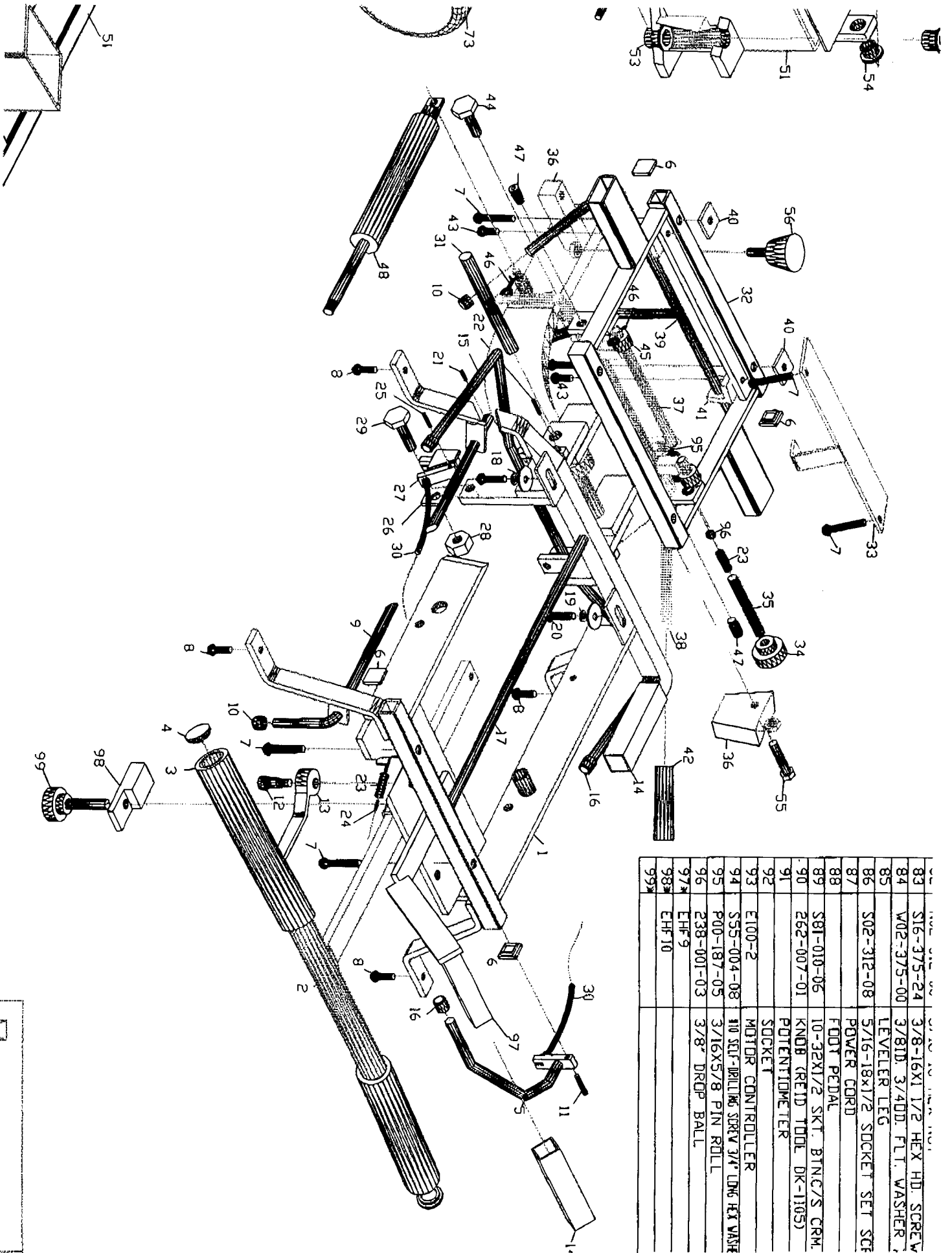

83	S16-375-24	3/8-16X1 1/2 HEX HD. SCREW
84	W02-375-00	3/8ID. 3/4OD. FLT. WASHER
85	S02-312-08	LEVELER LEG
86	S16-18X1/2	SOCKET SET SCF
87		POWER CORD
88		FOOT PEDAL
89	S81-010-06	10-32X1/2 SKT. BIN/C/S CRM.
90	E62-007-01	KNOB (REID TOOL DK-1105)
91		POTENTIOMETER
92	E100-2	SOCKET
93		MOTOR CONTROLLER
94	S55-004-08	10 SELF-DRILLING SCREW 3/4" LONG HEX WASH
95	P00-187-05	3/16X5/8 PIN ROLL
96	Z38-001-03	3/8" DROP BALL
97*	EHF 9	
98*	EHF 10	
99*		

PARTS LIST

NO.	PART NO.	DESCRIPTION	QTY.
1	EHF1	HEADPIECE FRONT ASSY.	1
2	EHF2	TRACTION BAR ASSY.	1
3	UST241-1	8.5" HANDLE COVER	2
4	UST241-1	RASIC COVER FOR 1/4"X1/2"X1/8" (W/1888K10)	2
5	EHF4	HEADPIECE TILT LEVER	1
6	UST241-2	PLASTIC COVER FOR 1/4"X1/2"X1/8" (W/1888K10)	4
7	S14-250-22	1/4"-20X1 1/2" PHIL. RD. HD.	14
8	S14-250-12	1/4"-20X3/4" PHIL. RD. HD.	4
9	EHF6	PAPER HOLDER ROD	1
10	9753K41	BLACK PLASTIC TIP FOR 3/8" ROD	3
11	S20-010-08	10-32X3/4" SDC. HD COP. SCREW	1
12	S25-000-13	5/16-18X1/2" SQUARE DR. SCREW	1
13	EHF8	LOCK HANDLE	1
14		4" HANDLE COVER	3
15	EHF5	LATERAL FLEXION RELEASE HANDLE	1
16	9753K16	BLACK PLASTIC TIP FOR 5/16" ROD	3
17		PLASTIC ROD	1
18	W01-250-00	1/4" FL. WASHER	2
19	W06-250-00	1/4" HED. SPL. LOCK WASHER	2
20	S14-250-16	1/4"-20X1" PHIL. RD. HD.	2
21	P00-125-05	ROLL PIN 1/8X5/8	2
22	P00-156-05	ROLL PIN 5/32X5/8	2
23	P00-093-03	COMPRESSION SPRING	3
24	P00-125-03	ROLL PIN 3/32X3/8	2
25	P00-125-07	ROLL PIN 1/8X7/8	4
26	EHF3	CABLE HOLDER	1
27	EHF7	GAS TUBE MOUNT ASSY.	1
28	N03-375-00	3/8-16 NYLON STOP NUT	1
29	S16-375-24	3/8-16X1 1/2" HEX HD. SCREW	1
30	R20-007-01	ACTIVATION CABLE	1
31	EHF3	PIVOT ROD	2
32	EHF1	DORSAL FRAME ASSY.	1
33	EHF5	DORSAL CUSHION MOUNT PLATE	1
34	UST239-58	KNOB	2
35	EHF9	TREADED ROD	2
36	EHF2	BREAKAWAY FRAME ASSY.	2
37	EHF4	DRIP SUPPORT	1
38	EHF3	DORSAL DRIP HANDLE ASSY.	2
39	EHF6	BREAKAWAY RELEASE HANDLE	2

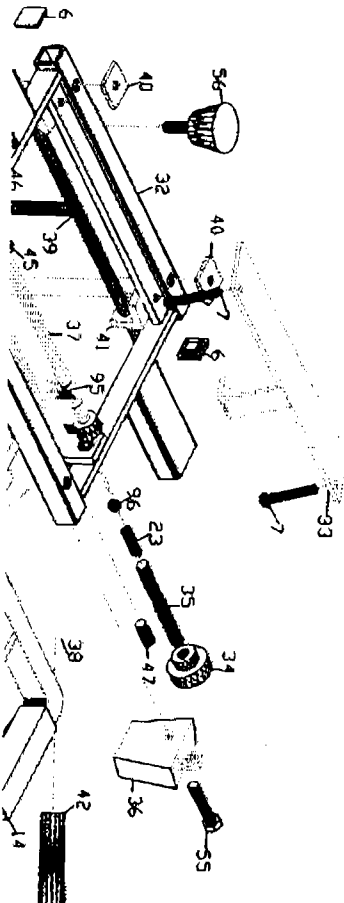

NO.	PART NO.	DESCRIPTION	QTY.
40	EHF6	RUBBER SPACER	4
41	EHF7	PLASTIC ANGLE	24
42	262-036-00	HANDLE	4
43	S14-250-10	1/4"-20X5/8" PHIL. RD. HD.	2
44	S16-375-20	3/8-16X1 1/4" HEX HD. SCREW	1
45	EHF10	PLASTIC ROLLER	4
46	P01-125-06	1/8X3/4 CUT PIN	5
47	S02-375-42	3/8" ST. SCREW WITH 1/8"X1/2" SPT TIP LC 1/4"	4
48		GAS CYLINDER 'VARLOCK'	1
49	213-012-20	METALDR M85-114	1
50	97345619	5/16-18 SHOULDER SCREW	1
51	EHF1	STATIONARY BASE FRAME ASSY.	1
52	EHF5	PIVOT SHAFT	1
53	UST358-1	BRONZE BUSHING 5/8ID 3/4OD	2
54	S16-312-30	BRONZE BUSHING 1/2ID 5/8OD	2
55	S21-010-00	BRONZE BUSHING 1/2ID 5/8OD	2
56	261-010-00	BRONZE BUSHING 1/2ID 5/8OD	2
57	EHF1	PELVIC FRAME	1
58	EHF4	SLIDE ROD	1
59	EHF2	FLEXION PUSH BAR	2
60	213-012-01	METALDR M85-115	1
61	973456716	SHLDR. BOLT 3/8-16	2
62		CLIP	2
63		BRONZE BUSHING	2
64		WASHER	11
65	N02-375-00	3/8-16 HEX NUT	2
66	EHF1	MAIN LEVER	1
67	EHF5	LOCK RELEASE HANDLE	1
68	EHF2	FOOT REST SUPPORT	1
69	EHF3	CUSHION RTG.	1
70		BRONZE BUSHING 5/8ID 3/4 OD	2
71	S16-375-16	3/8-16X1 HEX HD. SCREW	1
72	S16-375-32	3/8-16X2 HEX HD. SCREW	1
73	E100-1	MOTOR 3/4HP	1
73-1		GEAR BOX	1
74	EHF2	MOTOR FRAME ASSY.	1
75	EHF4	LEG	2
76	UST241-3	RASIC COVER FOR 1/4"X1/2"X1/8" (W/1888K10)	4
77		BASE COVER SET	1
78		FOAM	1
79		CLIP NUT	4
80		RUBBER SPACER	4
81	EHF6	5/16-18X2 1/4" TREADED ROD	4
82	N02-312-00	5/16-18 HEX NUT	8
83	S16-375-24	3/8-16X1 1/2" HEX HD. SCREW	4
84	W02-375-00	3/8ID 3/4OD FL. WASHER ZNK	4
85		LEVELER LEG	4
86	S02-312-08	5/16-18X1/2 SOCKET SET SCREW	2
87		POWER CORD	1
88		FOOT PEDAL	1
89	S81-010-06	10-32X1/2 SKT. BTNLCS CRM	5
90	262-007-01	KNOB GREID TDBL DR-11051	1
91		POTENTIOMETER	1
92		SOCKET	2
93	E100-2	MOTOR CONTROLLER	1
94	S55-004-08	10 SELF-DRILLING SCREW 3/4" LONG HEX WASHER UNDERDRILL DR	6
95	P00-187-05	3/16X5/8 PIN ROLL	2
96	238-001-03	3/8" DRIP BALL	2
97	EHF9		1
98	EHF10		1
99			1